

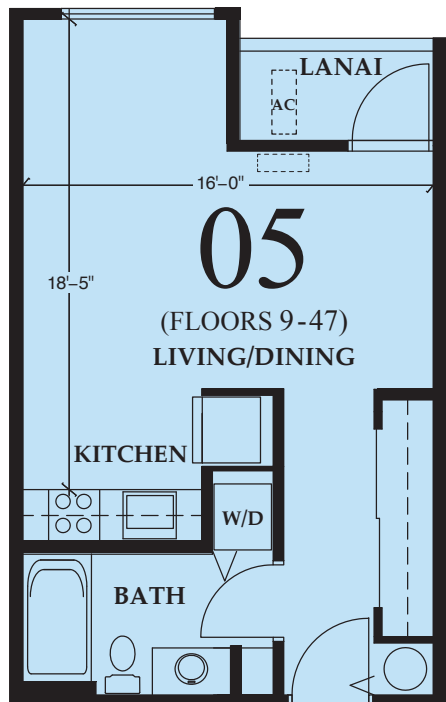

**2013 Features:**

- (1) Carpeting in living area
- (2) Vinyl flooring in bathroom and kitchen
- (3) Grab bar in tub area
- (4) Window coverings
- (5) Granite kitchen countertops
- (6) 18.2 cubic foot refrigerator, disposal, 24" range and hood
- (7) Stacked washer/dryer and 50 gal. water heater
- (8) 12,000 BTU split air conditioner in living area
- (9) Poured concrete walls between apartments
- (10) Double pane glass windows & lanai door



---

**Apartment 05/09\***  
**FLOORS 9-47**

**Studio**

<b>Living Area</b>	<b>381 sq. ft.</b>
<b>Lanai</b>	<b>26 sq. ft.</b>
<b>TOTAL AREA</b>	<b>407 sq. ft.</b>

\*Rooms may be reversed in location

Downtown Capital LLC reserves the right to discontinue, substitute, or change products or design without notice or obligation. All dimensions and square footages are approximate. See the public report for the description of the unit.